

HikDashcam AE-DC2032-V300 User Manual

A Legal Statement

© 2025 Hangzhou HikAuto Technology Co., Ltd. All rights reserved. Specifications subject to change without notice.

HikAuto Technology Co., Ltd. is a division of Hikvision Digital Technology, Ltd., No.555 Qianmo Road, Binjiang District, Hangzhou 310051, China Tel: +86-571-8807-5998

About this Manual

The Manual includes instructions for using and managing the Product. Pictures, charts, images, and all other information hereinafter are for description and explanation only. The information contained in the Manual is subject to change, without notice, due to firmware updates or other reasons.

Trademarks

- **HIKVISION** and other Hikvision trademarks and logos are the properties of Hikvision in various jurisdictions.
- Other trademarks and logos mentioned are the properties of their respective owners.

Disclaimer

TO THE MAXIMUM EXTENT PERMITTED BY APPLICABLE LAW, THIS MANUAL AND THE PRODUCT DESCRIBED, WITHITS HARDWARE, SOFTWARE AND FIRMWARE, ARE PROVIDED “AS IS” AND “WITH ALL FAULTS AND ERRORS.”HIKAUTO MAKES NO WARRANTIES, EXPRESS OR IMPLIED, INCLUDING WITHOUT LIMITATION, MERCHANTABILITY, SATISFACTORY QUALITY, OR FITNESS FOR A PARTICULAR PURPOSE. THE USE OF THE PRODUCT BY YOU IS AT YOUR OWN RISK. IN NO EVENT WILL HIKAUTO BE LIABLE TO YOU FOR ANY SPECIAL, CONSEQUENTIAL, INCIDENTAL, OR INDIRECT DAMAGES, INCLUDING, AMONG OTHERS, DAMAGES FOR LOSS OF BUSINESS PROFITS, BUSINESS INTERRUPTION, OR LOSS OF DATA, CORRUPTION OF SYSTEMS, OR LOSS OF DOCUMENTATION, WHETHER BASED ONBREACH OF CONTRACT, TORT (INCLUDING NEGLIGENCE), PRODUCT LIABILITY, OR OTHERWISE, IN CONNECTION WITHTHE USE OF THE PRODUCT, EVEN IF HIKAUTO HAS BEEN ADVISED OF THE POSSIBILITY OF SUCH DAMAGES OR LOSS.

YOU ACKNOWLEDGE THAT THE NATURE OF INTERNET PROVIDES FOR INHERENT SECURITY RISKS, AND HIKAUTO SHALL NOT TAKE ANY RESPONSIBILITIES FOR ABNORMAL OPERATION, PRIVACY LEAKAGE OR OTHER DAMAGES RESULTING FROM CYBER-ATTACK, HACKER ATTACK, VIRUS INFECTION, OR OTHER INTERNET SECURITY RISKS; HOWEVER, HIKAUTO WILL PROVIDE TIMELY TECHNICAL SUPPORT IF REQUIRED. YOU AGREE TO USE THIS PRODUCIN COMPLIANCE WITH ALL APPLICABLE LAWS, AND YOU ARE SOLELY RESPONSIBLE FOR ENSURING THAT YOUR USECONFORMS TO THE APPLICABLE LAW. ESPECIALLY, YOU ARE RESPONSIBLE, FOR USING THIS PRODUCT IN A MANNER THAT DOES NOT INFRINGE ON THE RIGHTS OF THIRD PARTIES, INCLUDING WITHOUT LIMITATION, RIGHTS OFPUBLICITY, INTELLECTUAL PROPERTY RIGHTS, OR DATA PROTECTION AND OTHER PRIVACY RIGHTS. YOU SHALL NOTUSE THIS PRODUCT FOR ANY PROHIBITED END-USES, INCLUDING THE DEVELOPMENT OR PRODUCTION OF WEAPONSO F MASS DESTRUCTION, THE DEVELOPMENT OR PRODUCTION OF CHEMICAL OR BIOLOGICAL WEAPONS, ANYACTIVITIES IN THE CONTEXT RELATED TO ANY NUCLEAR EXPLOSIVE OR UNSAFE NUCLEAR FUEL-CYCLE, OR IN SUPPORT OF HUMAN RIGHTS ABUSES.

IN THE EVENT OF ANY CONFLICTS BETWEEN THIS MANUAL AND THE APPLICABLE LAW, THE LATTER PREVAILS.

C Packing List

- | | |
|--|--|
| 1 Dashcam × 1 | 5 4-Lead Hardware Kit Power Cable × 1 |
| 2 Rear Camera × 1 and Connector Cable × 1 | 6 User Manual × 1 |
| 3 Accessory Package × 1 | 7 Eject Pin × 1 |
| 4 Electrostatic Sticker × 1 | |

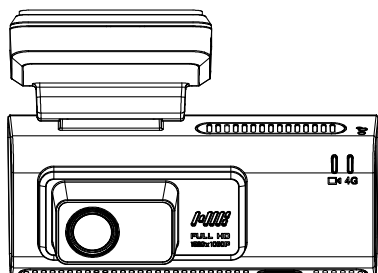
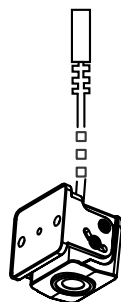
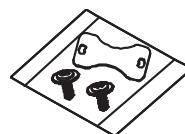
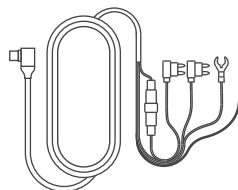
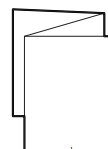
**1****2****3****4****5****6****7**

D Parts Introduction

1 3M Adhesive Pad

2 Lens

3 USB Interface

Note: USB interface is for power supply only.

4 Rear Camera Port

5 Eject Pin Hole of MicroSD (TF) Slot

6 Speaker

7 4G / GPS Indicator and Power Indicator

**Check the 4G/GPS silk screen printing according to the actual selection.*

8 Reset Button

9 Snapshot Button

10 MicroSD (TF) Slot

11 SIM Card 1 & 2 Slot (optional)

**When GPS version is selected, no SIM card slot.*

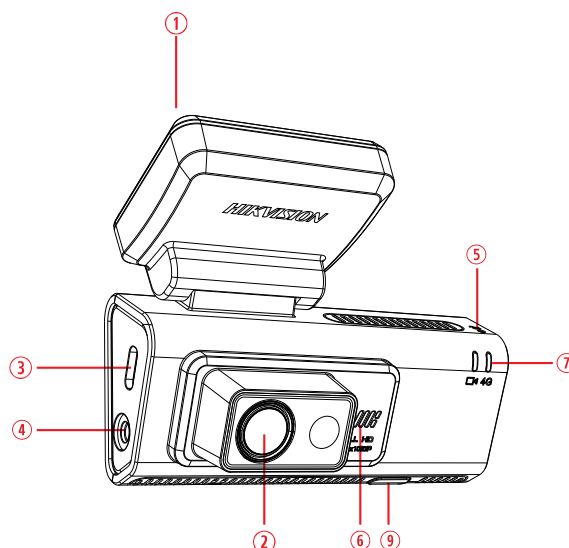

Figure 1, Left View

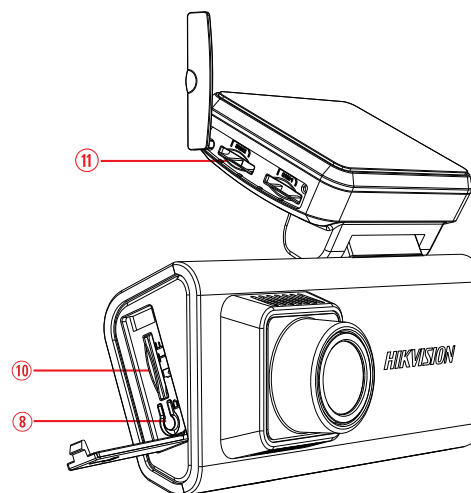

Figure 2, Right View

E Install Dashcam

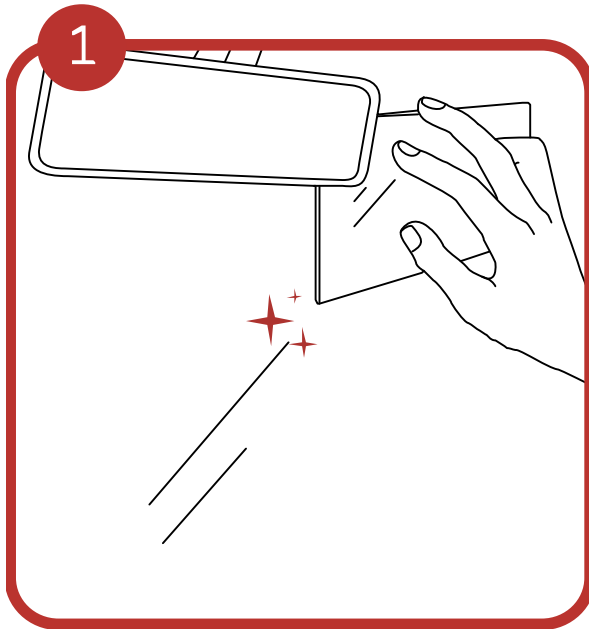

Figure 3, Apply Electrostatic Sticker

Clean the windshield and paste the electrostatic sticker onto the windshield.

NOTE: The electrostatic sticker prevents residual marks and allows window cleaning and dashcam repositioning.

Avoid introducing air bubbles. DO NOT reapply the film repeatedly.

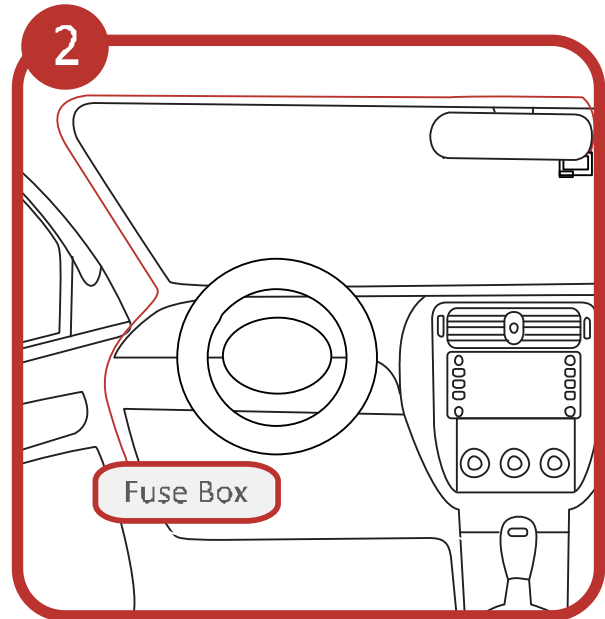

Figure 4, Route Cable to Fuse Box

Paste the device onto the electrostatic sticker and route cable to the fuse box for power.

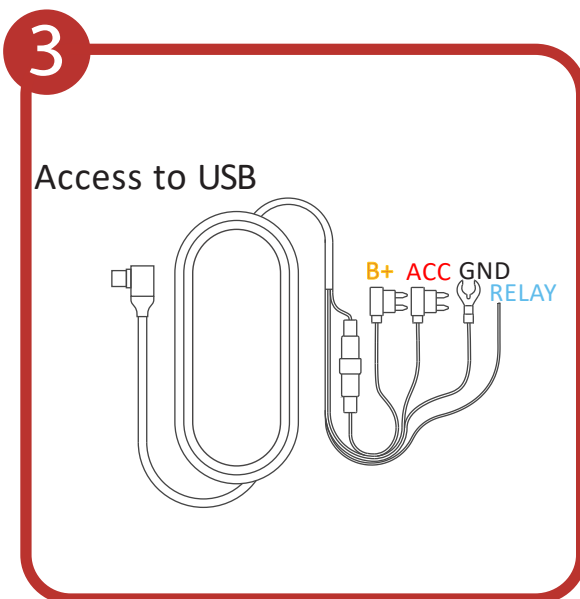

Figure 5, Connect Power Cord

Connect the power cord as per the above figure.

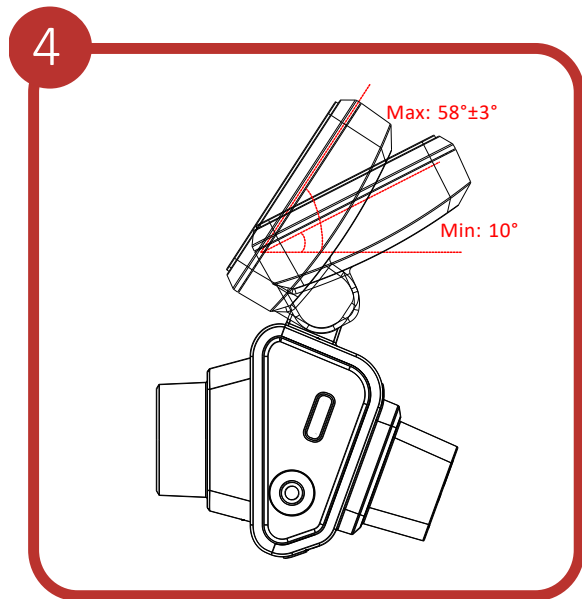

Figure 6, Adjust Dashcam Angle

Adjust the angle to the target direction.

F Install Rear Camera

OPTION 1: Exterior Mounting

- 1 Peel off the adhesive release paper on the camera bracket. Install the camera centered directly above the license plate so that it points at the road.
- 2 Connect the rear camera to the front dashcam by routing the cable as per the following diagram:

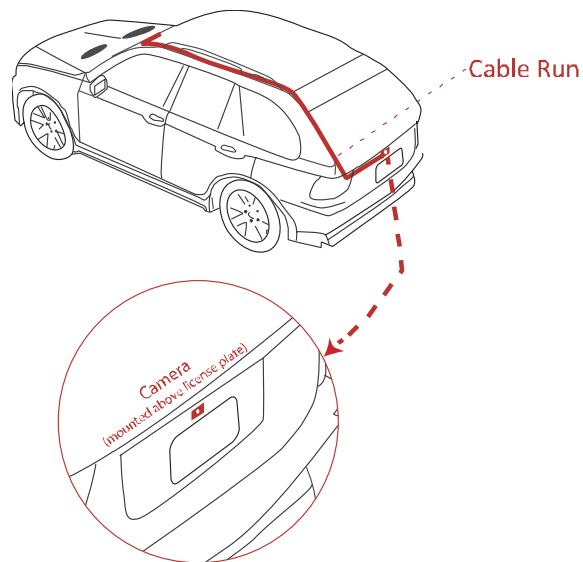

Figure 7, Rear Camera Exterior Cable Run



Figure 8, Rear Camera Exterior Placement

F Install Rear Camera

OPTION 2: Interior Mounting

- 1 Peel off the adhesive release paper on the camera bracket. Install the camera onto the top center of the rear window (interior side) so that it points directly at the road.
- 2 Connect the camera to the front dashcam by routing the cable as per the following diagram:

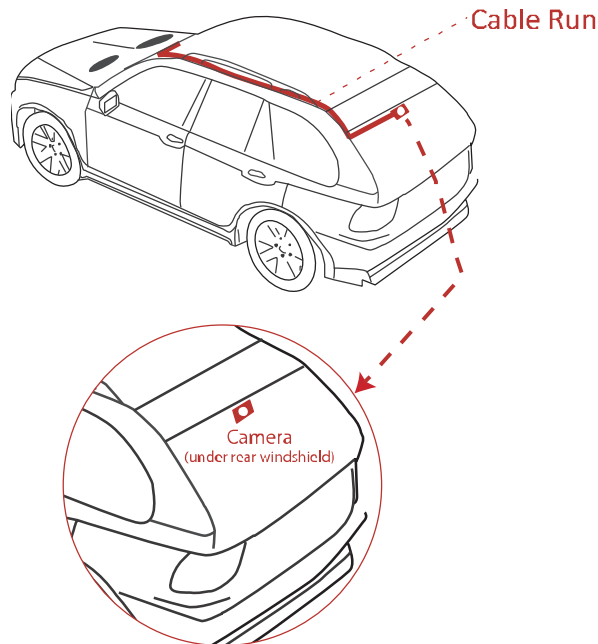

Figure 9, Rear Camera Interior Cable Run



Figure 10, Rear Camera Interior Placement on Rear Windshield
(Option 1)



Figure 11, Rear Camera Interior Placement on Rear Windshield
(Option 2)

NOTE: AE-DC2032-V300 is only supported for exterior installation.

G Mobile Phone Connection

- 1 Scan the QR code to download and install the HikDashcam app to your mobile phone.

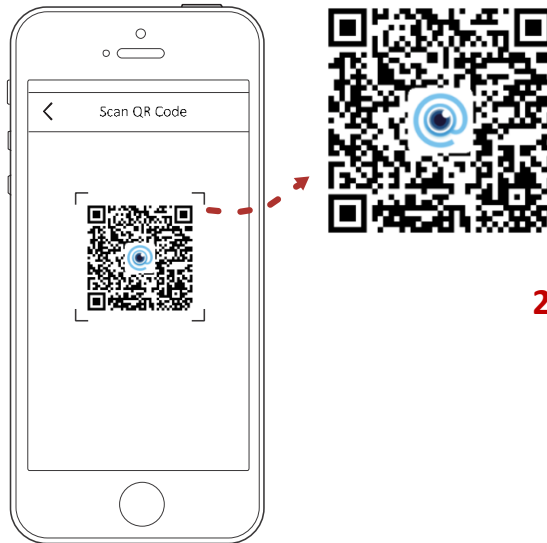

Figure 11, Scan QR Code for HikDashcam

- 2 Add the dashcam to the app.
 - a. Run the HikDashcam app.
 - b. Tap Wi-Fi Connection.
 - c. In the Wi-Fi list, select the target dashcam's Wi-Fi SSID and enter the Wi-Fi password to establish a connection.
- 3 Edit the dashcam password to activate to avoid abnormal recording after connecting the Wi-Fi.

- You can set the dashcam parameters.
 - For iOS, go your phone's Wi-Fi settings and connect to the dashcam Wi-Fi.
- i** Dashcam Wi-Fi default parameters:
- Wi-Fi SSID: hikvision-xxxx-xxxx (xxxx refers to the last four verification code characters).
 - Wi-Fi password by default is 1234567890
 - Create a new password after first login.

H Basic Operations

Recording

Power on the dashcam and start to recording .

- **Auto capture:** When the car is hit or shaken, the dashcam senses vibrations and captures the current video.
- **Manual capture:** Press snapshot button to capture the current picture. To associate with the current video, it needs to be set up in the app.

Note: The total capacity of emergency video files accounts for about 20% of the current memory card capacity. When the emergency video file reaches the upper limit, the new emergency video file will overwrite the original file. It is recommended to check regularly.

Insert TF Card

Use a card needle to stamp the small hole with the label  and open the TF card lock slot for card replacement.

Note: The two SIM cards cannot work simultaneously. SIM card 1 takes effect by default and can be switched to another SIM card in the hikdashcam app.

Parking Mode

The device automatically goes into parking mode after 5s delay when the automobile engine is shut off (only if using a three lead buck line cable connected directly to the fuse box) and the device continues to record at 1 fps.

Note: 1) In the high temperature of summer, when the temperature inside the car exceeds 60 °C, it is recommended that the user turn off the dashcam to avoid abnormal operation due to high temperature.

2) It is recommended to turn off the parking monitoring function when the vehicle is not in use for a long time to avoid feeding. The equipment protection voltage is $11.8V \pm 0.2V$.

Firmware Upgrade

Step 1: Run the HikDashcam app.

Step 2: Connect to the dashcam you would like to upgrade.

Step 3: Tap the **Upgrade** button to upgrade the firmware.

***When upgrading, do not power off or unplug the card.**

Indicator & Button & Power Cable

Recording Indicator

Normal recording: Blue light is on.

Parking and monitoring: Blue light flashes.

Abnormal recording: Red light is on.

Upgrading: Red and blue lights flash alternately.

4G/GPS Indicator

4G:

No 4G signal: Blue light is off.

Online: Blue light is on.

4G signal but offline: Blue light flashes.

GPS:

No GPS signal: Blue light is off.

Location: Blue light is on.

GPS signal but not location: Blue light flashes.

Snapshot Button

Press to photo.

Reset Button

Press to reset the dashcam.

Power Cable

B+ (Yellow): Supply power

ACC (Red): ACC check

GND (Black): Grounding

Relay (Blue): When the external voltage drops from 3.3V to 0V, the device will start recording and continue for 1 minute before shutting down. When the device detects the next 3.3V-0V fluctuation, it will wake up again and start recording for 1 minute.

I Specifications

AE-DC2032-V300	
Camera	
Image Sensor	CMOS
Resolution	Front: 1080P, interior: 720P, rear: 1080P
Angle Adjustment	Front: Horizontal 111°, vertical 58°, diagonal 134° Interior: Horizontal 105°, vertical 58°, diagonal 124° Rear: Horizontal 102°, vertical 53°, diagonal 124°
Aperture	Front: F2.0, interior: F2.2, rear: F2.0
Video Compression	H.265
Image Format	JPEG
Storage	TF Card: 32 GB to 256 GB
Communication Module	Wi-Fi, 4G[CAT1](optional)
Sensor	G-sensor, GPS
Interfaces	
Power Supply	Type C
Audio Input	Mic
Audio Output	Built-in loudspeaker
General	
Working Temperature	-20° to 70° C (-4° to 158° F)
Working Humidity	0% to 95%
Power Supply	12 VDC, 2 A
Power Consumption	≤ 6.5 W
Dimension (L x W x H) (w/o Bracket)	Approx. 101.3 mm × 43.8 mm × 43.7 mm (4.0" × 1.7" × 1.7")
Weight (Approximate)	130 g (0.29 lb)

J Cautions

Safety Instructions

These instructions are intended to ensure that users can use the product correctly to avoid danger or property loss.

Cautions

Injury or equipment damage may occur if any of the cautions are neglected.

- In the use of the dashcam, you must be in strict compliance with the local laws and regulations.
- You are recommended to install the dashcam near the rear mirror to ensure the dashcam can record with the best road view. DO NOT install the dashcam in a location that will block the driver's sight. Keep the user manual for future reference. See initial connection of dashcam in the user manual.
- Purchase the microSD (TF) card from a legal channel. To ensure safe and stable data transmission, it is recommended to use a microSD (TF) card of V30 or above.
- Format the new microSD (TF) card before using the card.
- To protect the microSD (TF) card from damage, shut down the dashcam before inserting and pulling out the microSD (TF) card.
- Operating temperature is from -20° to 70° C (-4° to 158° F).
- To protect the dashcam, DO NOT use it in high temperature, low temperature, or high-humidity environments. Protect the dashcam from rain and dust.
- This Manual is subject to updates. The dashcam functions may vary by model.
- The device's driving assistance function only sends alarm or warning to the driver and cannot replace the driver's judgment. DO NOT rely only on the driving assistance function.
- It is required to use industrial grade SIM cards (MP2) and prohibit to use regular grade SIM cards (MP1). Our company is not responsible for any issues caused by the use of regular grade SIM cards.

K Troubleshooting

Trouble	Solution
The dashcam falls off easily	<ul style="list-style-type: none"> • Clean the windshield before installation. • Check that the 3M adhesive pad is tightly adhered to the electrostatic film before installation.
Starting the dashcam failed	<ul style="list-style-type: none"> • Check whether the vehicle is started and the power supply is normal. • Check whether the car charger is tightly connected. • Restore to defaults: Hold the RESET button until the startup music is heard.
The dashcam powers off easily	<ul style="list-style-type: none"> • Make sure the power cord is in good condition. • Make sure the power cord is tightly connected to the appropriate interfaces.
Recording is abnormal and indicator is unlit	<ul style="list-style-type: none"> • Make sure that the dashcam started up successfully. Check that the microSD (TF) card is inserted. Check the microSD (TF) card status, e.g., its format and its lifespan. Change the microSD (TF) card if there are problems.
Recording is blurred	<ul style="list-style-type: none"> • Make sure the protective film has been removed. • Check that the windshield and the dashcam lens are clean.
Recording is muted	<ul style="list-style-type: none"> • Set audio settings on the device or turn on sound recording in the HikDashcam app. • Turn on sound through the dashcam's audio control function.
Dashcam reboots itself	<ul style="list-style-type: none"> • Check that the 12 V power is tightly connected.
Mobile phone cannot connect to the dashcam	<ul style="list-style-type: none"> • Make sure the HikDashcam app is installed. Re-pair the dashcam to the app.
The mobile phone cannot display recordings	<ul style="list-style-type: none"> • Check the player or your phone system. Connect the microSD (TF) card to your computer and display the recordings.
The microSD (TF) card is not detected when connecting the dashcam to a computer with the supplied power cord	<ul style="list-style-type: none"> • The dashcam does not support data transmission, and the supplied power cord is only for charging. • If you need to transfer data, connect the microSD (TF) card to your computer.

K Troubleshooting

Connecting to Wi-Fi
takes a long time

- Check interference from surrounding Wi-Fi signals. Use the dashcam in an environment where there is less interference.
- Shut down unnecessary programs and apps on your phone to release some resources for the HikDashcam app, then reconnect the Wi-Fi.

Dashcam Wi-Fi
password is forgotten

- The default password is 1234567890. If you have revised the password, reset the password by doing the following:
 1. Hold the **RESET** button on the dashcam until the startup music is heard, the dashcam will be restored to the defaults.
 2. Go to the HikDashcam app's Wi-Fi connection interface.
 3. Select the Wi-Fi SSID, and log in with the default password 1234567890.

No GPS signal

- Check whether the GPS function is enabled. Normally, the GPS function is enabled by default. Make sure the device is not in a location with a weak signal or no signal such as underground garage.
- Make sure there is no metal around the device because metal can interfere with the GPS signal.
- Make sure the location where the device is installed has good GPS reception.

No 4G signal

- Check whether the 4G function is enabled. Normally, the 4G function is enabled by default. Make sure the device is not in a location with a weak signal or no signal such as underground garage.
- Make sure there is no metal around the device because metal can interfere with the 4G signal.
- Make sure the location where the device is installed has good 4G reception.