

## PTZ-N2D200M-DE/12 2 MP Smart Hybrid Light TandemVu PT Network Camera



- High quality imaging with 2 MP resolution
- Support Human Detection and Auto-tracking Lite
- Smart Hybrid Light: advanced technology with long range
- Hik-Connect cloud service and app for remote management and views of devices
- Built-in microphone and speaker for real-time audio security
- Built-in memory card slot, support microSD/SDHC/SDXC card, up to 512 GB
- Water and dust resistant IP66

## ▪ Specification

| Camera                      |   |
|-----------------------------|---|
| Image Sensor                | [Bullet channel]<br>1/2.9" Progressive Scan CMOS<br>[PTZ channel]<br>1/2.9" Progressive Scan CMOS   |
| Min. Illumination           | [Bullet channel]<br>Color: 0.01 Lux @ (F2.0, AGC ON), B/W: 0.01 Lux @ (F2.0, AGC ON), 0 Lux with IR<br>[PTZ channel]<br>Color: 0.01 Lux @ (F2.0, AGC ON), B/W: 0.01 Lux @ (F2.0, AGC ON), 0 Lux with IR                       |
| Shutter Speed               | 1 s to 1/30,000 s   |
| Slow Shutter                | Yes   |
| Day & Night                 | ICR   |
| Max. Resolution             | [Bullet channel] 1920 × 1080, [PTZ channel] 1920 × 1080   |
| Lens                        |   |
| Focal Length                | [Panoramic channel] 2.8 mm, [PTZ channel] 8 mm  |
| FOV                         | [Panoramic channel]<br>horizontal field of view: 105°, vertical field of view: 58°, diagonal field of view: 123°,<br>[PTZ channel]<br>horizontal field of view: 40°, vertical field of view: 22°, diagonal field of view: 46° |
| Aperture                    | [Bullet channel] F2.0, [PTZ channel] F2.0   |
| Illuminator                 |   |
| Supplement Light Type       | [Bullet channel] Hybrid (IR and White Light), [PTZ channel] Hybrid (IR and White Light)   |
| Supplement Light Range      | [Bullet channel]: up to 30 m, [PTZ channel]: up to 30 m   |
| Smart Supplement Light      | Yes   |
| PTZ                         |   |
| Movement Range (Pan)        | [Panoramic channel] 0° to 355°, [PTZ channel] 0° to 345°  |
| Movement Range (Tilt)       | [Bullet channel] 7° to 17° (manually adjust), [PTZ channel] 0° to 80°   |
| Pan Speed                   | Pan speed: configurable from 4° to 25°/s, preset speed: 25°/s   |
| Tilt Speed                  | Tilt speed: configurable from 4° to 20°/s, preset speed 20°/s   |
| Presets                     | 300   |
| Power-off Memory            | Yes   |
| Video                       |   |
| Main Stream                 | [Bullet channel]<br>50 Hz: 25 fps (1920 × 1080, 1280 × 720)<br>60 Hz: 30 fps (1920 × 1080, 1280 × 720)<br>[PTZ channel]<br>50 Hz: 25 fps (1920 × 1080, 1280 × 720)<br>60 Hz: 30 fps (1920 × 1080, 1280 × 720)                 |
| Sub-Stream                  | [Bullet channel]<br>50 Hz: 25 fps (640 × 480, 640 × 360)<br>60 Hz: 30 fps (640 × 480, 640 × 360)<br>[PTZ channel]<br>50 Hz: 25 fps (640 × 480, 640 × 360)<br>60 Hz: 30 fps (640 × 480, 640 × 360)                             |
| Scalable Video Coding (SVC) | Yes   |

|                             |  |
|-----------------------------|--|
| Region of Interest (ROI)    | 1 fixed region for main stream   |
| Video Compression           | Main stream: H.265/H.264/Smart264/Smart265,<br>Sub-stream: H.265/H.264/MJPEG   |
| Video Bit Rate              | 32 Kbps to 4 Mbps  |
| H.264 Type                  | Baseline profile, Main profile, High profile   |
| H.265 Type                  | Main profile   |
| <b>Audio</b>                |  |
| Audio Compression           | G.711/G.722.1/G.726/MP2L2/PCM/MP3/AAC-LC   |
| Audio Bit Rate              | 64 Kbps(G.711ulaw/G.711alaw)/16 Kbps(G.722.1)/16 Kbps(G.726)/32 to 160 Kbps(MP2L2)/16 to 64Kbps(AAC-LC)/8 to 160 Kbps(MP3)/8 to 48 Kbps(PCM)                       |
| Audio Sampling Rate         | 8 kHz/16 kHz   |
| Environment Noise Filtering | Yes  |
| <b>Network</b>              |  |
| API                         | ONVIF (ProfileS, ProfileG, ProfileT), ISAPI, SDK   |
| Security                    | Authenticated username and password, MAC address binding, HTTPS encryption, 802.1X authenticated access, IP address filter   |
| Protocols                   | TCP/IP, SMTP, RTSP, FTP, WebSockets, IGMP, WebSocket, Qos, RTCP, HTTPS, PPPoE, SNMP, NTP, RTP, UDP, DNS, HTTP, DHCP, Bonjour, 802.1x, IPv4, IPv6, DDNS, ICMP, UPnP |
| Simultaneous Live View      | Up to 20 channels  |
| User/Host                   | Up to 32 users. 3 user levels: administrator, operator, and user   |
| Client                      | iVMS-4200, HiLookVision  |
| Web Browser                 | Chrome 57+, Firefox 52+, Safari 12+  |
| <b>Image</b>                |  |
| Image Settings              | Saturation, brightness, contrast, sharpness  |
| Wide Dynamic Range (WDR)    | Digital WDR  |
| SNR                         | ≥ 52 dB  |
| Day/Night Switch            | Day, night, auto, schedule   |
| Image Enhancement           | BLC, HLC, 3D DNR   |
| Privacy Mask                | [Bullet channel] 4 programmable polygon privacy masks, [PTZ channel] 4 programmable polygon privacy masks  |
| Image Parameters Switch     | Yes  |
| <b>Interface</b>            |  |
| Ethernet Interface          | 1 RJ45 10 M/100M self-adaptive Ethernet port   |
| On-board Storage            | Built-in memory card slot, support microSD/microSDHC/microSDXC card, up to 512 GB  |
| Reset                       | Yes  |
| <b>Event</b>                |  |
| Basic Event                 | Motion detection (support alarm triggering by specified target types (human and vehicle)), exception   |
| Linkage                     | Upload to FTP/NAS/memory card, notify surveillance center, send email, trigger recording, audible warning  |
| <b>General</b>              |  |
| Weight                      | Weight: 1000 g (2.2 lb.)<br>With Package Weight: 1500 g (3.3 lb.)  |
| Material                    | PC   |
| General Function            | Mirror, password protection, watermark, IP address filter  |

|                     |  |
|---------------------|--|
| Power               | 12 VDC $\pm$ 25%, 1.5 A, max. 18 W, $\varnothing$ 5.5 mm coaxial power plug, reverse polarity protection,<br>PoE: IEEE 802.3at, Class 4, max. 21.5 W |
| Operating Condition | -30 °C to 50 °C (-22 °F to 122 °F). Humidity 95% or less (non-condensing)  |
| Dimension           | 134 mm $\times$ 213.5 mm $\times$ 291.7 mm (5.3" $\times$ 8.4" $\times$ 11.5")   |
| <b>Approval</b>     |  |
| Protection          | IP66 Standard, Surge Protection and Voltage Transient Protection   |

## ▪ Typical Application

Hikvision products are classified into three levels according to their anti-corrosion performance. Refer to the following description to choose for your using environment.

This model has NO SPECIFIC PROTECTION.

| Level                  | Description  |
|------------------------|--|
| Top-level protection   | Hikvision products at this level are equipped for use in areas where professional anti-corrosion protection is a must. Typical application scenarios include coastlines, docks, chemical plants, and more.   |
| Moderate protection    | Hikvision products at this level are equipped for use in areas with moderate anti-corrosion demands. Typical application scenarios include coastal areas about 2 kilometers (1.24 miles) away from coastlines, as well as areas affected by acid rain. |
| No specific protection | Hikvision products at this level are equipped for use in areas where no specific anti-corrosion protection is needed.  |

## ▪ Available Model

PTZ-N2D200M-DE/12(2.8/8mm)

▪ Dimension

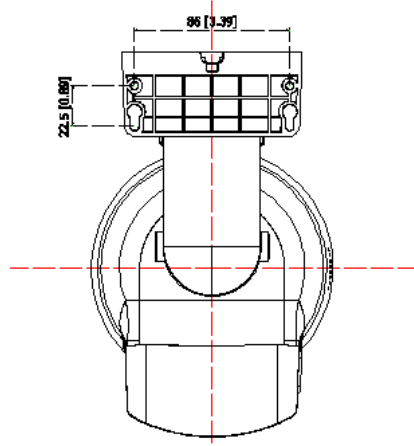
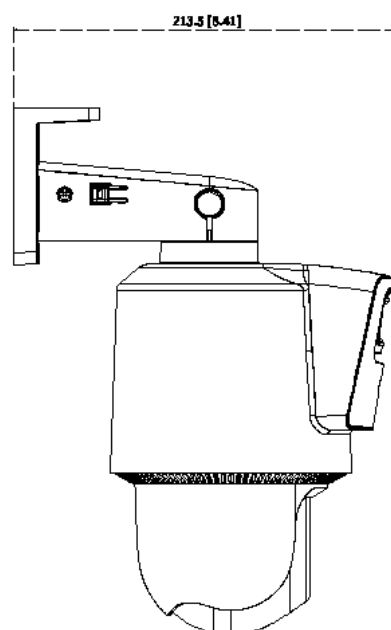
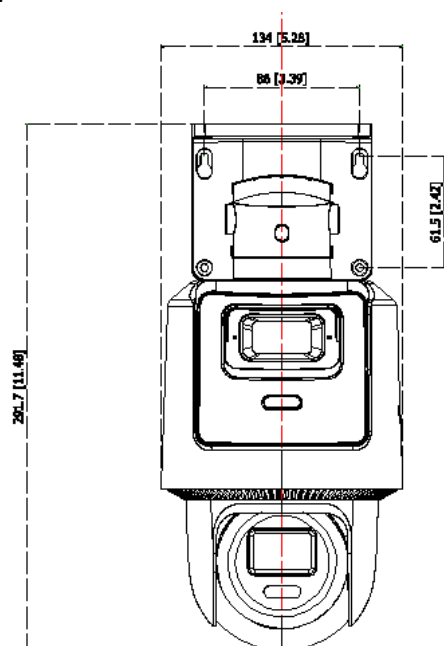

SPEC  
Unit: mm (inch)

# See Far, Go Further



[www.hikvision.com](http://www.hikvision.com)  
[support@hikvision.com](mailto:support@hikvision.com)



© Hangzhou Hikvision Digital Technology Co., Ltd. Unless otherwise agreed, Hikvision makes no warranties, express or implied. We reserve the right to introduce modifications without notice.

# HiLook