

DS-2CD6B25G0-PLWC03 2MP Wireless Macro Camera



- High quality imaging with 2 MP resolution
- Easy installation with small lens and recommended within 5 cm to 20 cm of object
- Water and dust resistant (IP67)
- Supports white light and 24/7 colorful imaging
- Built-in battery with ultra-low power consumption, capable of lasting 6 years with one daily wake-up and capture
- Realize Wi-Fi connection with coverage up to 100 m in open areas

▪ Specification

Camera	
Max. Resolution	1600 × 1200,others: 1280 × 720, 640 × 480, 320 × 240
Min. Illumination	Color: 0.05 Lux @ (F1.2, AGC ON)
Shutter Time	1/6 s to 100,000 s
Lens	
Focal Length & FOV	4 mm, horizontal FOV 94.2°, vertical FOV 76.9°, diagonal FOV 115.8°
Lens Type	Fixed focal lens, 4 mm
Iris Type	Fixed
DORI	
DORI	D: 82.2 m, O: 32.6 m, R: 16.4 m, I: 8.2 m
Illuminator	
Supplement Light Type	White Light
Supplement Light Range	Up to 0.2 m
Network	
API	Open Network Video Interface, ISAPI, SDK, ISUP
User/Host	Up to 32 users 3 user levels: administrator, operator, and user
Network Storage	NAS (NFS, SMB/CIFS),NVR
Client	iVMS-4200,Hik-Connect,HCP
Web Browser	Plug-in required live view: IE 10, IE 11, Plug-in free liveview: Chrome 57.0+, Firefox 52.0+, Edge 89+, Safari 11+, Local service: Chrome 57.0+, Firefox 52.0+, Edge 89+
Wi-Fi	
Wi-Fi Protocol	IEEE802.11b,IEEE802.11g,IEEE802.11n
Frequency Range	2.4 GHz to 2.4835 GHz
Channel Bandwidth	20/40 MHz
Modulation	802.11b: CCK, QPSK, BPSK, 802.11g/n: OFDM
Wireless Range	Up to 100 m (The performance varies based on actual environment)
Image	
Wide Dynamic Range (WDR)	Digital WDR
Day/Night Switch	Auto
Image Enhancement	BLC,3D DNR
Interface	
Reset Key	Yes,support magnetic reset
General	
Power	3.6 VDC ± 20%, 1 A, max. 3.6 W,Built-in battery, non-rechargeable
Material	Main body: Plastic
Dimension	93 mm × 61.2 mm × 36 mm (3.66" × 2.41" × 1.42")
Package Dimension	187 mm × 122 mm × 55 mm (7.36" × 4.8" × 2.17")
Weight	Approx. 190 g (0.419 lb.)
With Package Weight	Approx. 360 g (0.794 lb.)
Storage Conditions	-30 °C to 60 °C (-22 °F to 140 °F). Humidity 95% or less (non-condensing)

Startup and Operating Conditions	-30 °C to 60 °C (-22 °F to 140 °F). Humidity 95% or less (non-condensing)
Language	33 languages: English, Russian, Estonian, Bulgarian, Hungarian, Greek, German, Italian, Czech, Slovak, French, Polish, Dutch, Portuguese, Spanish, Romanian, Danish, Swedish, Norwegian, Finnish, Croatian, Slovenian, Serbian, Turkish, Korean, Traditional Chinese, Thai, Vietnamese, Japanese, Latvian, Lithuanian, Portuguese (Brazil), Ukrainian
Approval	
EMC	CE-EMC: EN 55032:2015+A1:2020, EN 50130-4:2011+A1:2014, EN IEC 61000-3-2:2019+A1:2021, EN 61000-3-3:2013+A1:2019+A2:2021
Safety	CB: IEC 62368-1: 2014, CE-LVD: EN 62368-1: 2014/A11: 2017
Environment	CE-RoHS: 2011/65/EU, WEEE: 2012/19/EU, Reach: Regulation (EC) No 1907/2006
RF	CE-RED: EN 301 489-1 V2.2.3, EN 301 489-17 V3.2.4, EN 300 328 V2.2.2, EN IEC 62311: 2020
Protection	IP67: IEC 60529-2013

▪ Typical Application

Hikvision products are classified into three levels according to their anti-corrosion performance. Refer to the following description to choose for your using environment.

This model has NO SPECIFIC PROTECTION.

Level	Description
Top-level protection	Hikvision products at this level are equipped for use in areas where professional anti-corrosion protection is a must. Typical application scenarios include coastlines, docks, chemical plants, and more.
Moderate protection	Hikvision products at this level are equipped for use in areas with moderate anti-corrosion demands. Typical application scenarios include coastal areas about 2 kilometers (1.24 miles) away from coastlines, as well as areas affected by acid rain.
No specific protection	Hikvision products at this level are equipped for use in areas where no specific anti-corrosion protection is needed.

▪ Available Model

DS-2CD6B25G0-PLWC03(4mm)

▪ Dimension

DS-2CD6B25G0-PLWC03

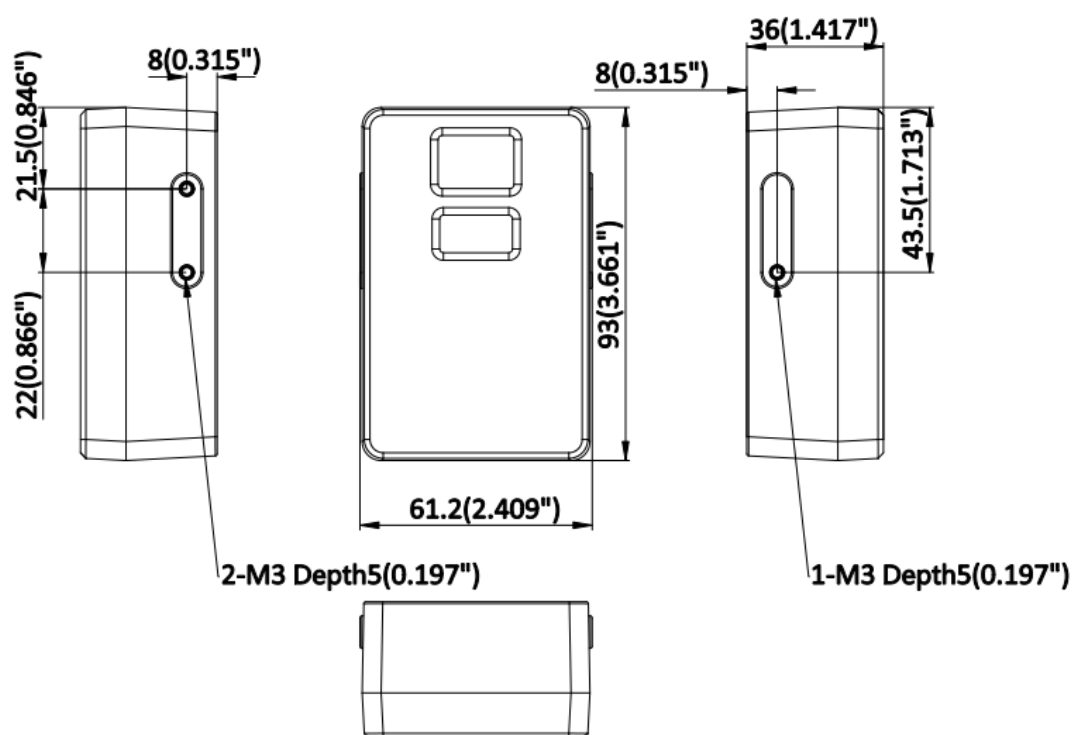

Unit:mm(inch)

Camera Mounting Hole (mm)	Camera Mounting Hole (inch)
3-M3	3-M0.118"

U-Shaped Mount

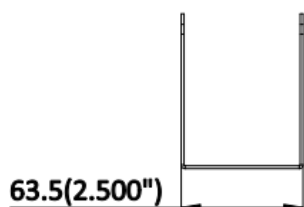
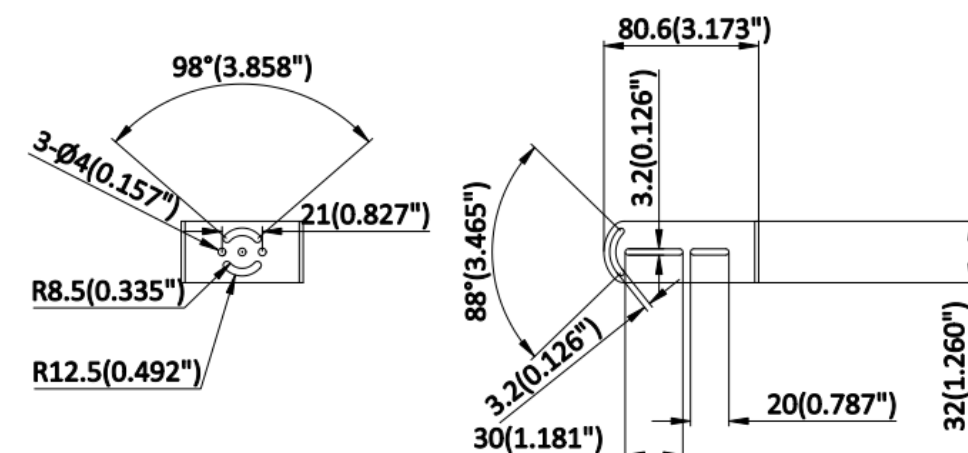

Unit:mm(inch)

Camera Mounting Hole (mm)	Camera Mounting Hole (inch)

Wall Mounting Hole (mm)	Wall Mounting Hole (inch)
3* ϕ 8.5	3* ϕ 0.335"

See Far, Go Further



www.hikvision.com
support@hikvision.com

