

Turbo HD DVR V4.84.001build250821 Release Notes

Reason of Upgrade

Modify the product design, add new functions and optimize the user experience.

Main update

1. All-channel analog channels support AcuSearch function

- a. Supports full-channel analog channel AcuSearch function, the system disables this function by default;
- b. Supports the simultaneous use of Motion 2.0 and AcuSearch function, originally only the perimeter function and AcuSearch function could be used simultaneously.
- c. Device Model Range: 72HQ/HU-M/XT, 72HU-M/PXT

2. AcuSearch function integration with HCT platform

- a. The AcuSearch function supports integration with the HCT platform.
- b. HCT Version: 6.10.0
- c. Device Model Range: 72HQ/HU-M/XT, 72HU-M/PXT

3. Support two-way audio function with 2K camera

- a. Support two-way audio function with 2K camera
- b. Device Model Range: 72HQ/HU-M/XT、72HU-M/PXT、71/72HQ-M/T、72HU-M/T

4. SmartSearch supports irregular regions with a maximum of 10 sides.

- a. The SmartSearch function expands the rule box to a maximum supported decagon
- b. Device Model Range: 72HQ/HU-M/XT、72HU-M/PXT

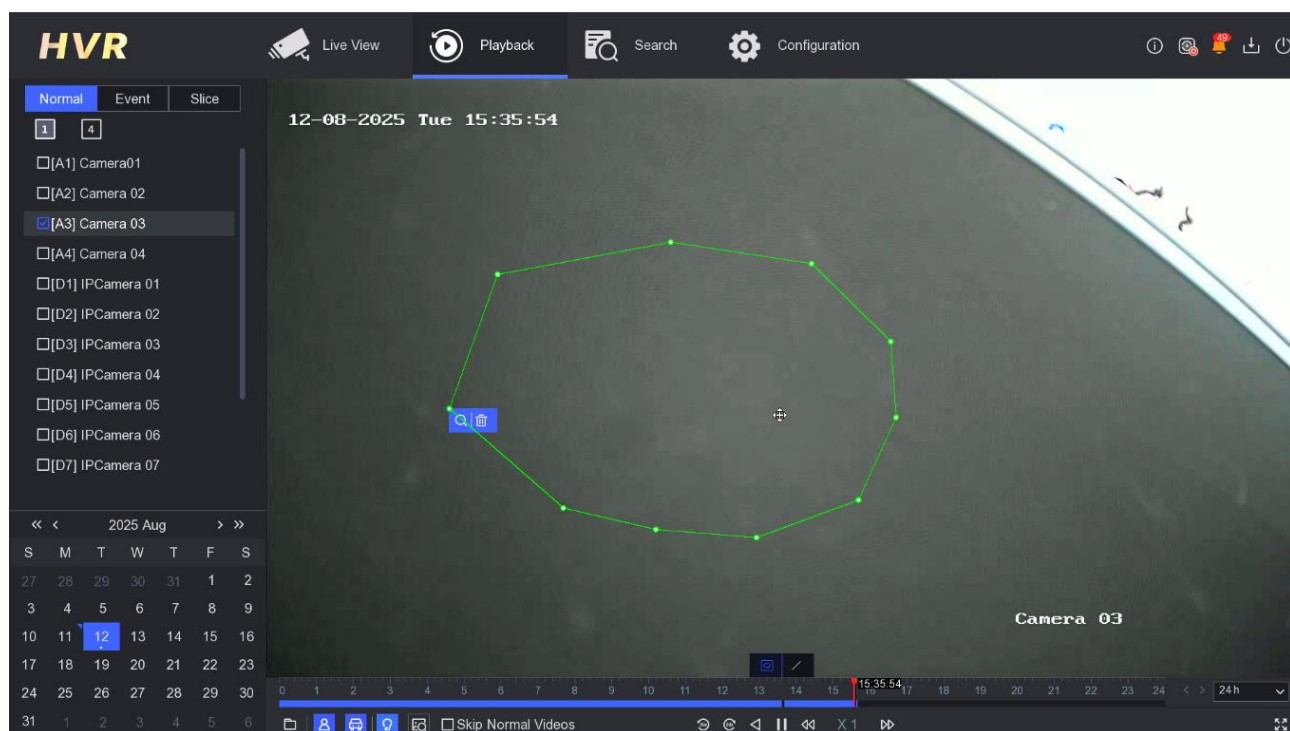

5. Supports Khmer language for the Cambodia region

- The local interface for Asian language packages supports Khmer in the Cambodia region
- Device Model Range: 72HQ/HU-M/XT, 72HU-M/PXT, 71/72HQ-M/T, 72HU-M/T, 71HQ-M/S, 72HQ-M/E

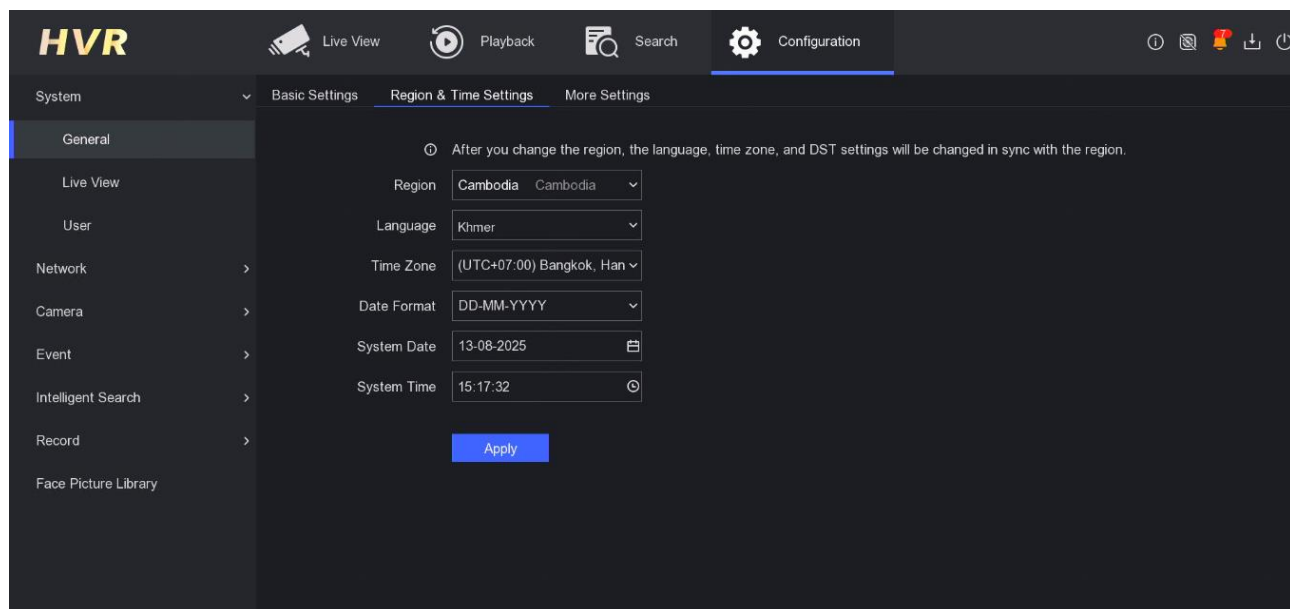

6. Email service address preset general mailbox

- The SMTP Server dropdown at the Email location presets Gmail and Yahoo email
- Select the preset email account to automatically associate SSL/TLS and port number configurations, email preset configuration:
Gmail port number: 587 Enable SSL/TLS

Yahoo port number: 587 Enable SSL/TLS

c. Device Model Range: 72HQ/HU-M/XT, 72HU-M/PXT, 71/72HQ-M/T, 72HU-M/T, 71HQ-M/S, 72HQ-M/E

HVR Live View Playback Search Configuration

System > Network > General > Platform Access > **Email**

Email Type: Other

Server Authentication: ☐

User Name:

Password:

SMTP Server: Gmail

SMTP Port: 587

SSL/TLS: ☒

Attached Picture: ☐

Sender:

Sender's Address:

Select Receivers: Receiver 1

Receiver:

Receiver's Address:

Apply Test

Easy Mode

HIKVISION Live View Playback Picture **Configuration**

Platform Access **Email** Network Service Wi-Fi Other Integration Protocol Log Server Settings

Type: Other

Sender:

Sender's Address:

SMTP Server: gmail

SMTP Port: 587

☒ Enable SSL/TLS

☐ Attached Image

Interval: 2 sec

☐ Authentication

User Name:

Password:

Confirm:

Receiver			
No.	Receiver	Receiver's Address	Test
1			<input type="button" value="Test"/>
2			<input type="button" value="Test"/>
3			<input type="button" value="Test"/>

Save

- a. Add short serial number display in system information for WEB and local
- b. Device Model Range: 72HQ/HU-M/XT、72HU-M/PXT、71/72HQ-M/T、72HU-M/T、71HQ-M/S、72HQ-M/E

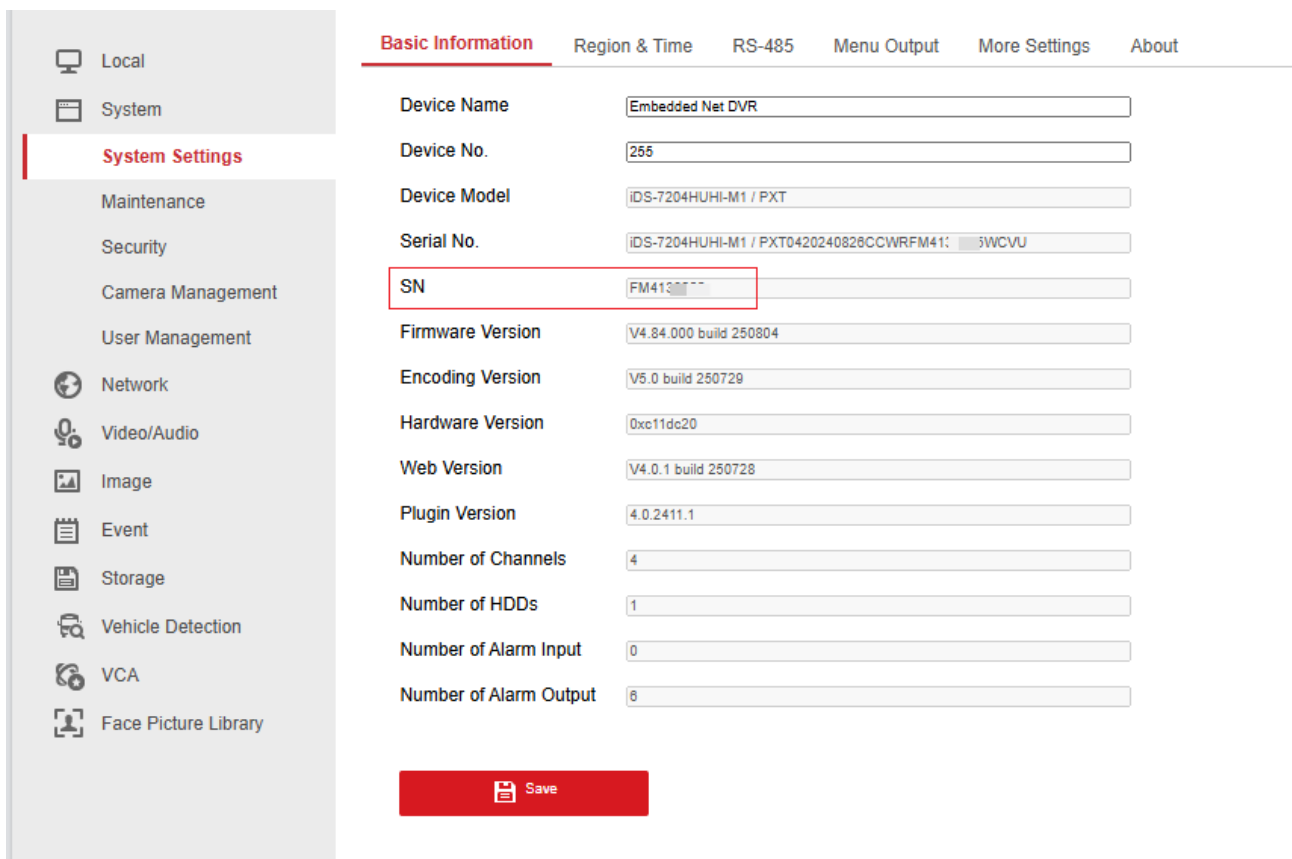

8. New negative pressure configuration item added for POC model

To resolve the issue of image distortion when POC models are used with AC-coupled cameras, a new negative pressure disable configuration has been added to the POC disable configuration interface. This configuration can only be enabled when PoC is disabled.

- After the negative pressure configuration is disabled, some front-end cameras (including PTZ dome cameras) may experience PTZ malfunction, which is a negative effect of enabling this configuration;
- After the negative pressure configuration is disabled, the AC coupled camera plug-in and plug-out signal will take effect in about 15 seconds to ensure normal image display;
- Device Model Range: 7204HU-M/PXT

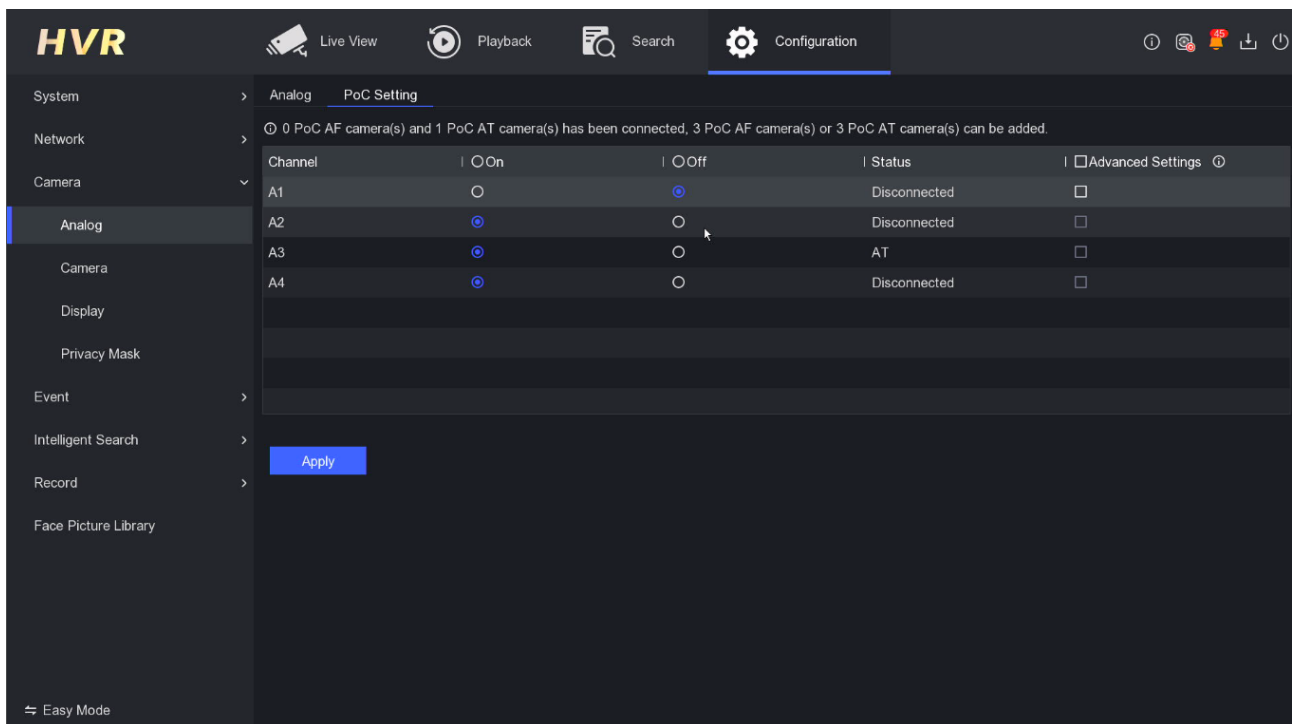

9. Outlook email supports the OAuth2.0 authentication method

- Outlook email's original account password method is no longer supported and has been upgraded to use the new OAuth2.0 authentication method for authentication
- Device Model Range: 72HQ/HU-M/XT, 72HU-M/PXT, 71/72HQ-M/T, 72HU-M/T, 71HQ-M/S, 72HQ-M/E

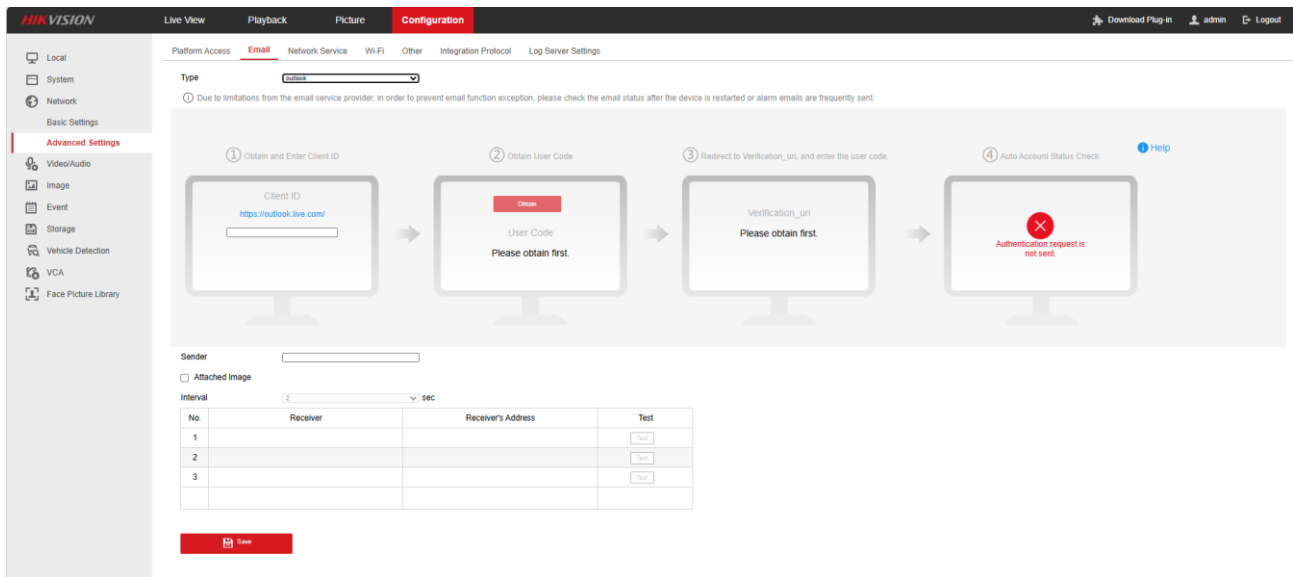
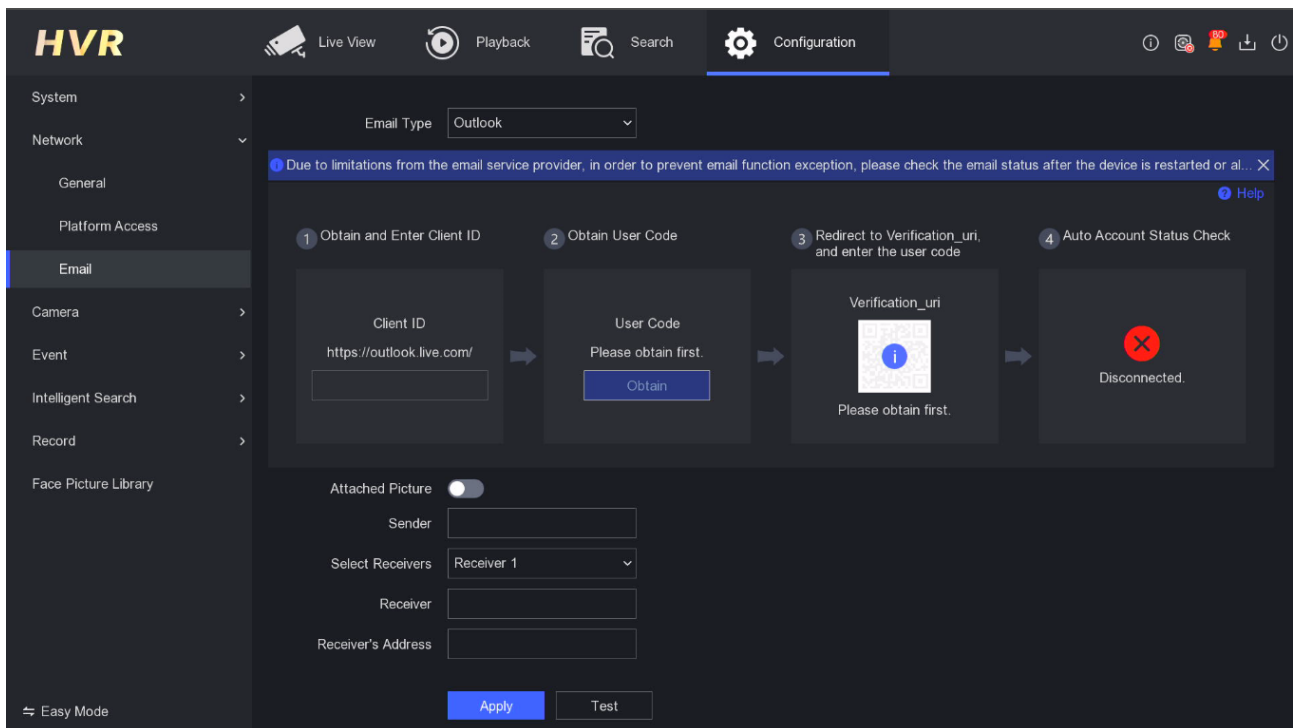

10. Search Interface Function Optimization

- Add AcuSearch function entry in the small window playback of event search result for user convenience
- Double-click to zoom in and double-click to zoom out function are added to the playback small window
- Right-click mouse to add return function
- Video, image, and event search results add chart mode

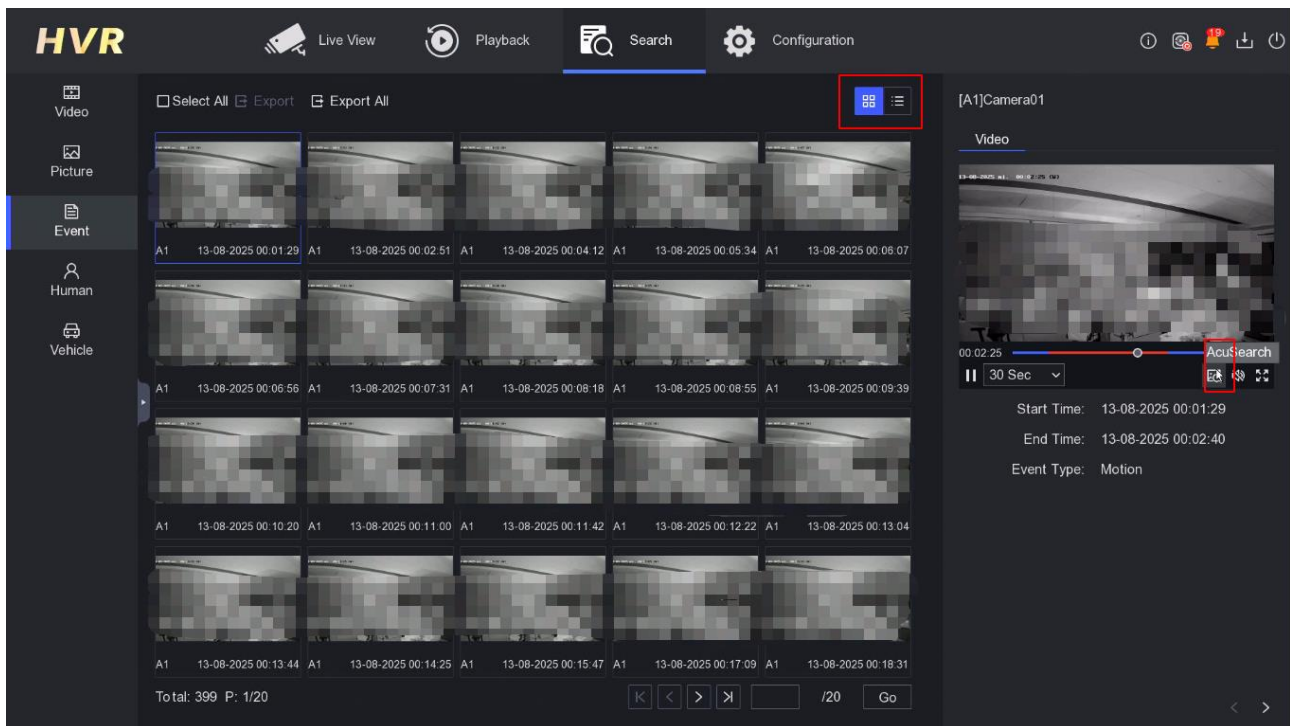

11. Acusearch Function Optimization

- Acusearch function search result adjustment: personnel default similarity 70%, vehicle default similarity 75%
- During the search process, progress is displayed. Results that meet the similarity requirements are prioritized. After the search is completed, the results are sorted and displayed, with a maximum of 500 search results displayed.
- Optimize modeling search strategy (proportional sampling priority modeling), so that when the modeling data volume is large, each channel has a certain number of target modeling detections
- Device Model Range: 72HQ/HU-M/XT, 72HU-M/PXT

12. Remote debugging and maintenance

- Support uploading device logs by user authorization through the Hik-Connect App
- Support setting the upload log time, and the exported module and level
- Device Model Range: 72HQ/HU-M/XT, 72HU-M/PXT

13. Supports PTRZ IPC camera configuration

- Support PTRZ camera configuration (including left, right and R), after connecting the PTRZ camera, the PTZ menu name is changed to PTRZ
- Supports PTZ lock, when locked, operating PTRZ displays PTRZ is locked
- Device Model Range: 72HQ/HU-M/XT, 72HU-M/PXT

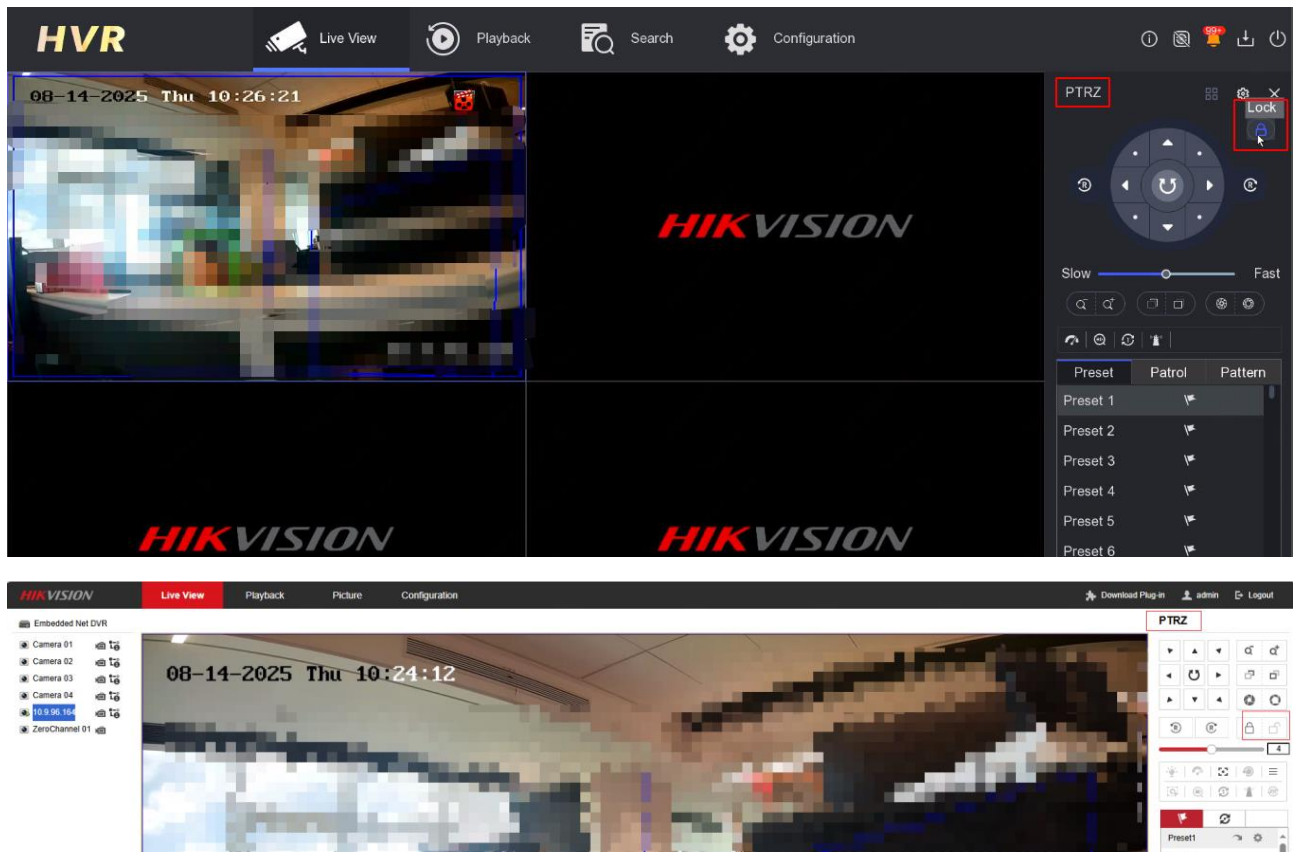

14. Modification of Associated Configuration for the Chile Region

After selecting the Chile region, the following default configuration is associated:

- Time zone selection -4 (always select -4, time zone changes are switched by DST)
- The device is enabled with NTP, IP is 200.27.106.115
- The device enables DST, start time: first Sun of September 00, end time: first Sun of April 00
- Device Model Range: 72HQ/HU-M/XT, 72HU-M/PXT, 71/72HQ-M/T, 72HU-M/T, 71HQ-M/S, 72HQ-M/E

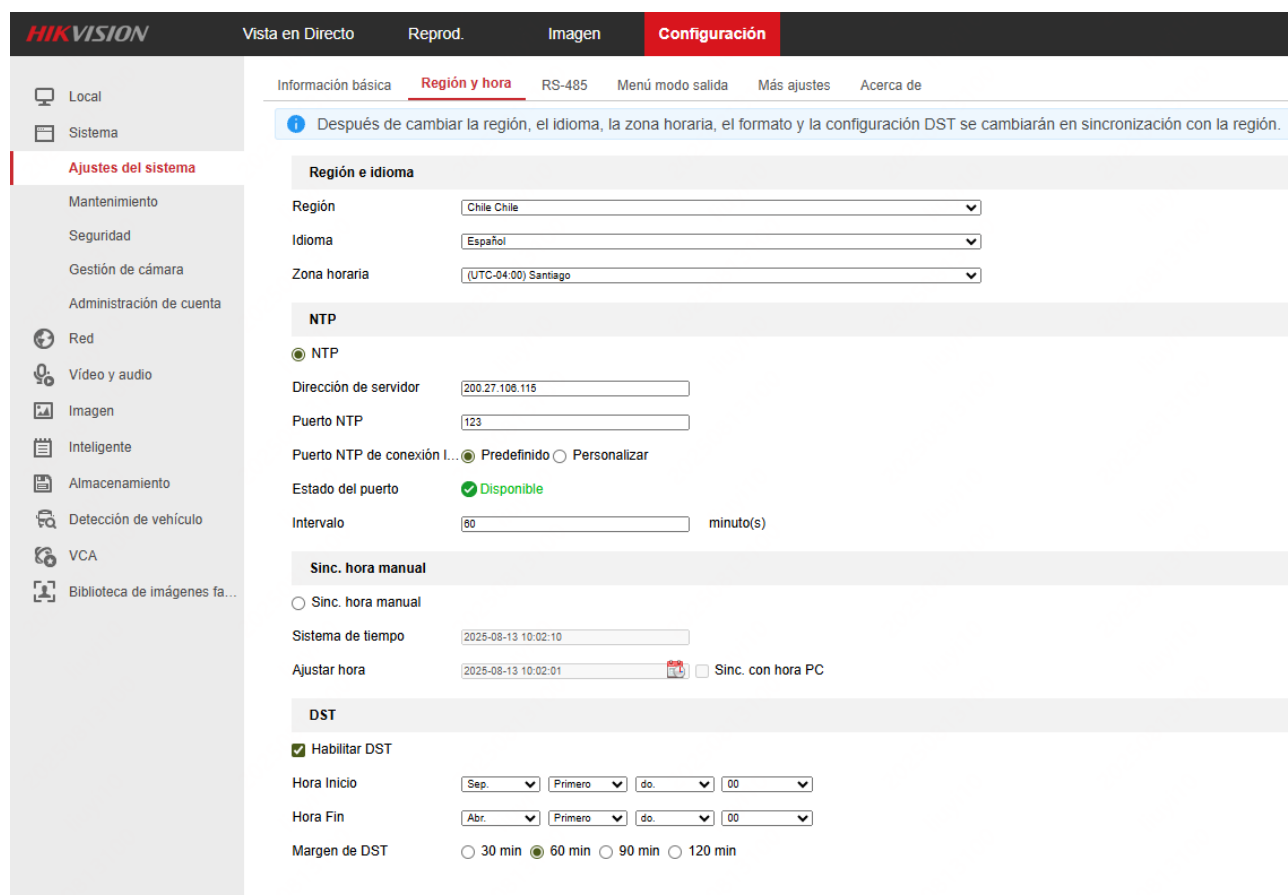
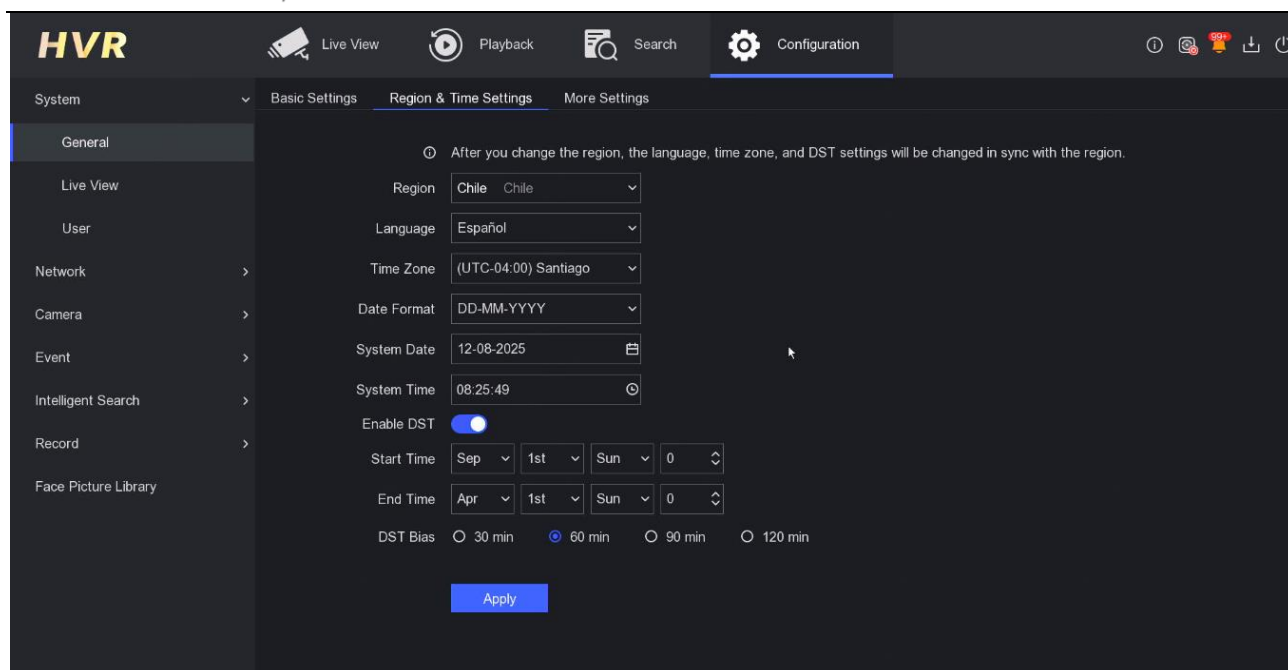

15. Add a prompt description in the advanced configuration of the recording schedule

- Added a note in the advanced configuration of the recording schedule: Videos and pictures that exceed the expiry time will be erased and cannot be restored. Note that the expiry time is distinct from the storage period.
- Device model range: 72HQ/HU/HT-M/XT, 72HU-M/PXT, 71/72HQ-M/T, 72HU-M/T, 71HQ-M/S, 72HQ-M/E

Cancel

1

1

1

1

1

1

1

1

1

1

1

1

1

1

1

Customer Impact and Recommended Action

This new firmware upgrade is to improve product performance, and will take effect automatically after upgrading from previous versions. We'd like to inform you the above changes. Also, we are sorry for any possible inconvenience of use-habit changes caused by this action.

For questions or concerns, please contact our local technical support team.

Note:

- Hikvision has all rights to alter, modify and cancel this notice.
- Hikvision doesn't give any guarantee for old models' stock.
- Hikvision is not liable for any typing or printing errors.
- For special model's change details, please contact our local technical support team.

Hikvision Digital Technology CO., Ltd.
No. 555 Qianmo Road, Binjiang District, Hangzhou 310052,
China
Tel: +86-571-8807-5998
FAX: +86-571-8993-5635
Email: support@hikvision.com